

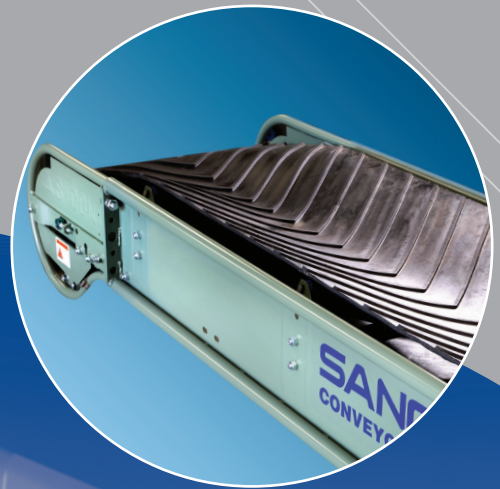

Sanwest

Sancon/Sanki Modular Belt Conveyors

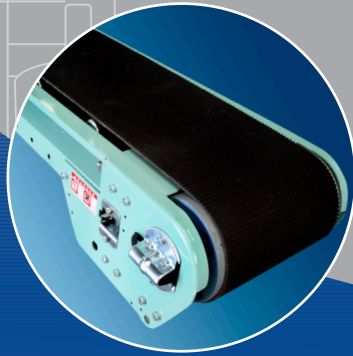

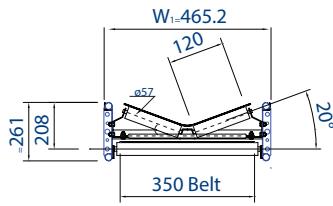
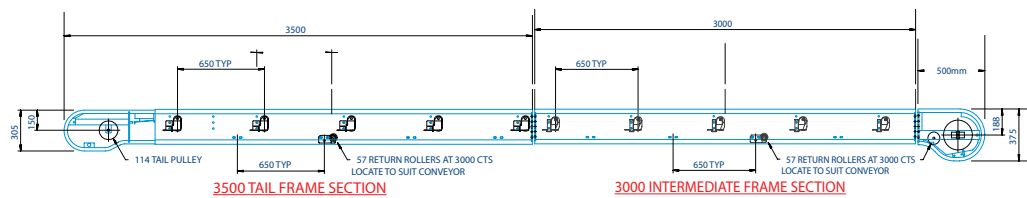

MR35

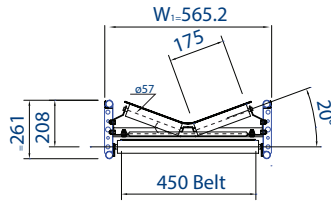

MR45

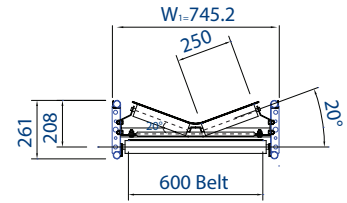

MR60

SANCON TROUGH MR

MODEL	BELT WIDTH (mm)	CONVEYOR LENGTH (m)		MAX CAPACITY (tph B/D of 1.5)	kW	BELT SPEED (m/min)	MACHINE WEIGHT (kg)
		OVERALL LENGTH	APPROX C/C				
MR35-4	350	4	3.5	30	1 (larger available)	35 (options available)	200
MR35-7		7	6.5				280
MR35-10		10	9.5				360
MR35-13		13	12.5				440
MR35-16		16	15.5				520
MR35-19		19	18.5				600
MR35-25		25	24.5				680
MR435-28		28	27.5				760
UP TO 50M							
MR45-4	450	4	3.5	50	1 or 1.5 (larger available)	35 (options available)	230
MR45-7		7	6.5				320
MR45-10		10	9.5				410
MR45-13		13	12.5				500
MR45-16		16	15.5				590
MR45-19		19	18.5				680
MR45-25		25	24.5				770
MR45-28		28	27.5				860
UP TO 50M							
MR60-4	600	4	3.5	100	1.5 (larger available)	35 (options available)	260
MR60-7		7	6.5				360
MR60-10		10	9.5				460
MR60-13		13	12.5				560
MR60-16		16	15.5				660
MR60-19		19	18.5				760
MR60-25		25	24.5				860
MR60-28		28	27.5				960
UP TO 50M							

NOTE:

- (i) Lengths – Lengths in between the above stated lengths are available.
- (ii) kW – Larger kW motors are available via an external gearbox drive arrangement.

BELTS – Smooth rubber, Chevron cleated rubber, PVC Smooth, Crescent top PVC etc.

MODEL MR

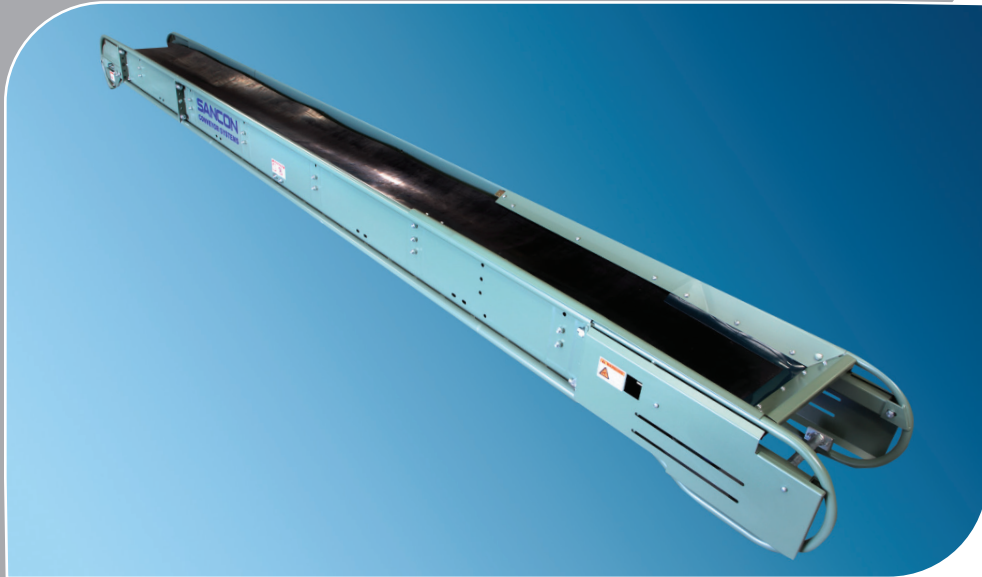

OPTIONS

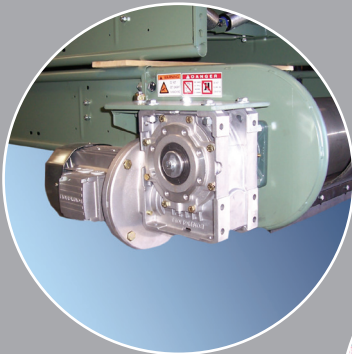

Head Conversion

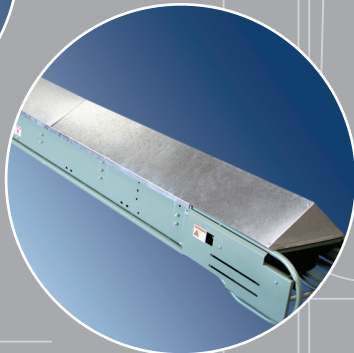

Cover



**Pull Wire
Switch Kit**



Support Brackets



Underspeed

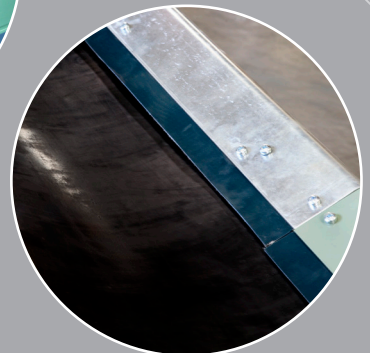

Skirts

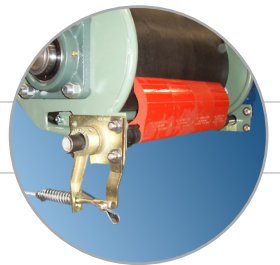

Scraper



Guards

Japanese/Australian Design and Components

MAJOR INDUSTRIES

- Mining
 - Iron Ore
 - Gold
 - Coal
 - Nickel
 - Mineral Sands
- Agriculture
- Materials Handling
- Vibration Equipment
- Quarry
- Fertiliser
- Food
- Concrete
- Packaging
- Recycling
- Plastics
- Bakeries
- Salt
- Pharmaceutical
- Woodchip



Authorised Distributor



Transmin HEAD OFFICE
Western Australia Office:

Ph: 1300 127 091
Address: 33-37 Denninup Way
Malaga, Perth,
Western Australia, 6090

